

Principedetail A
Kantstrook wegdekreflector
Schaal 120

Principedetail B
Kantstrook GÖW door middel van frezen
Schaal 120, maatvoering in mm

Principedetail C
Kantstrook GÖW d.m.v. blokjes: thermoplast; kleur zwart, hoog 6 mm
Schaal 120, maatvoering in mm

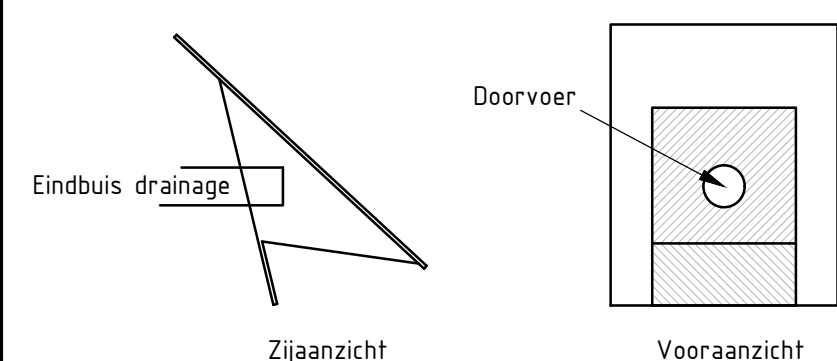

Principedetail G
HDPE-afstroombak drainage
Schaal 120 (maatvoering opzave leverancier)

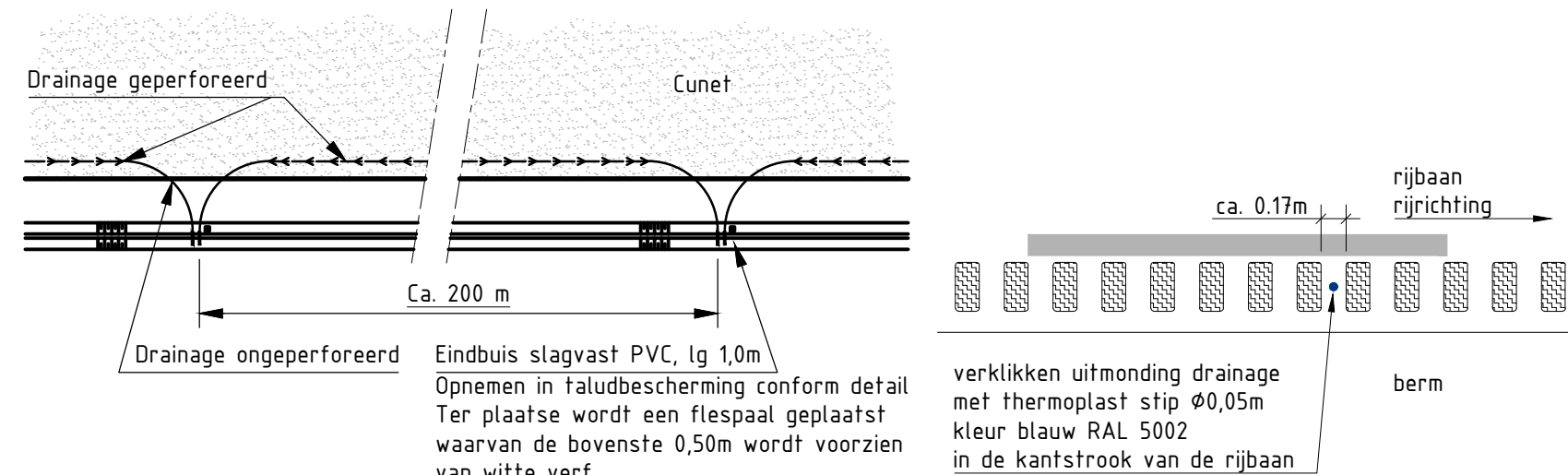

Principedetail H
Bovenaanzicht drainage
Niet op schaal

Principedetail I
Bovenaanzicht drainage
Niet op schaal

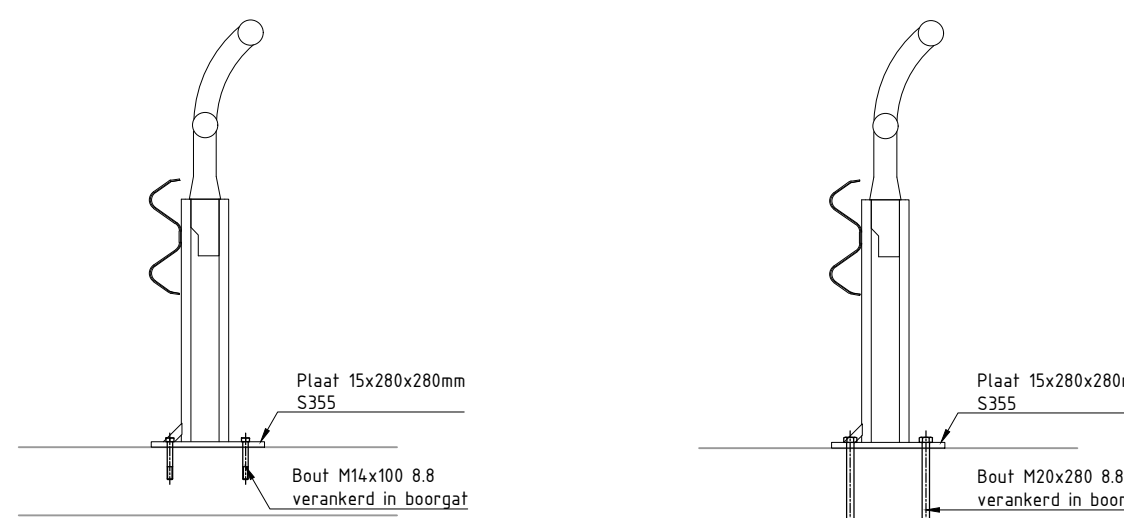

Principedetail J
Bevestiging geleiderail op brugdek
Schaal 120

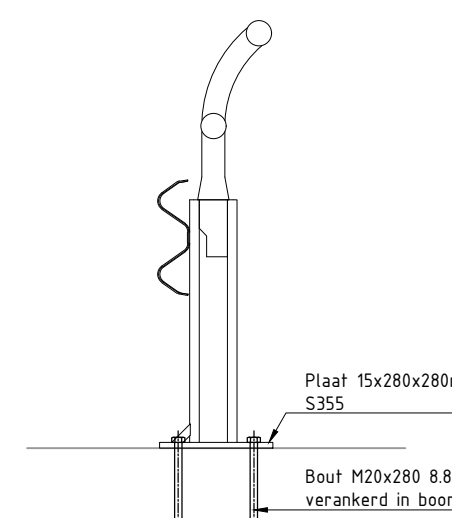

Principedetail J
Bevestiging geleiderail op dwarsbalk
Schaal 120

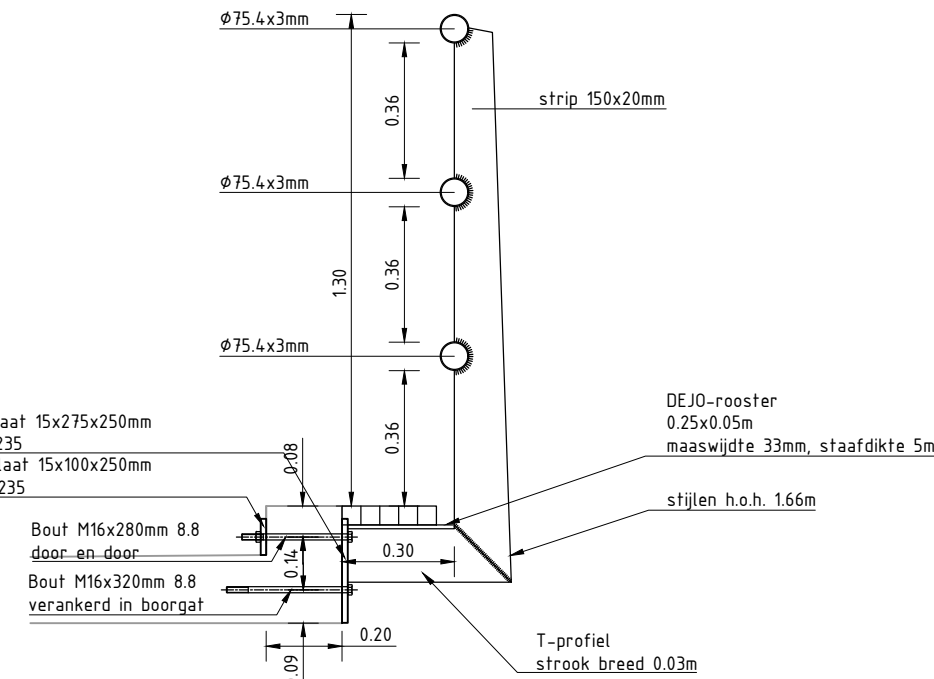

Principedetail K
Bevestiging leuning aan brug
Schaal 120

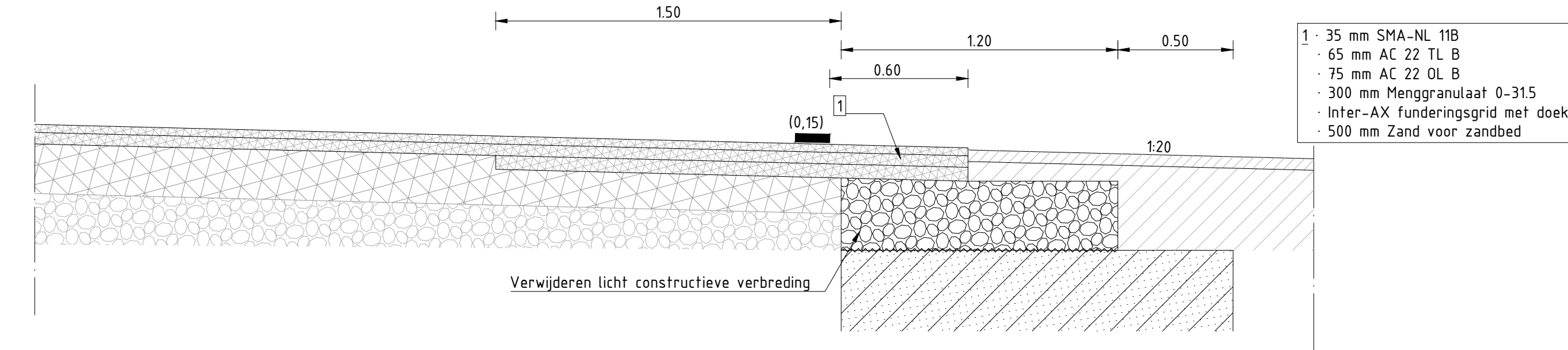

Principedetail F
Constructieopbouw verbredingen rijbaan
Schaal 120

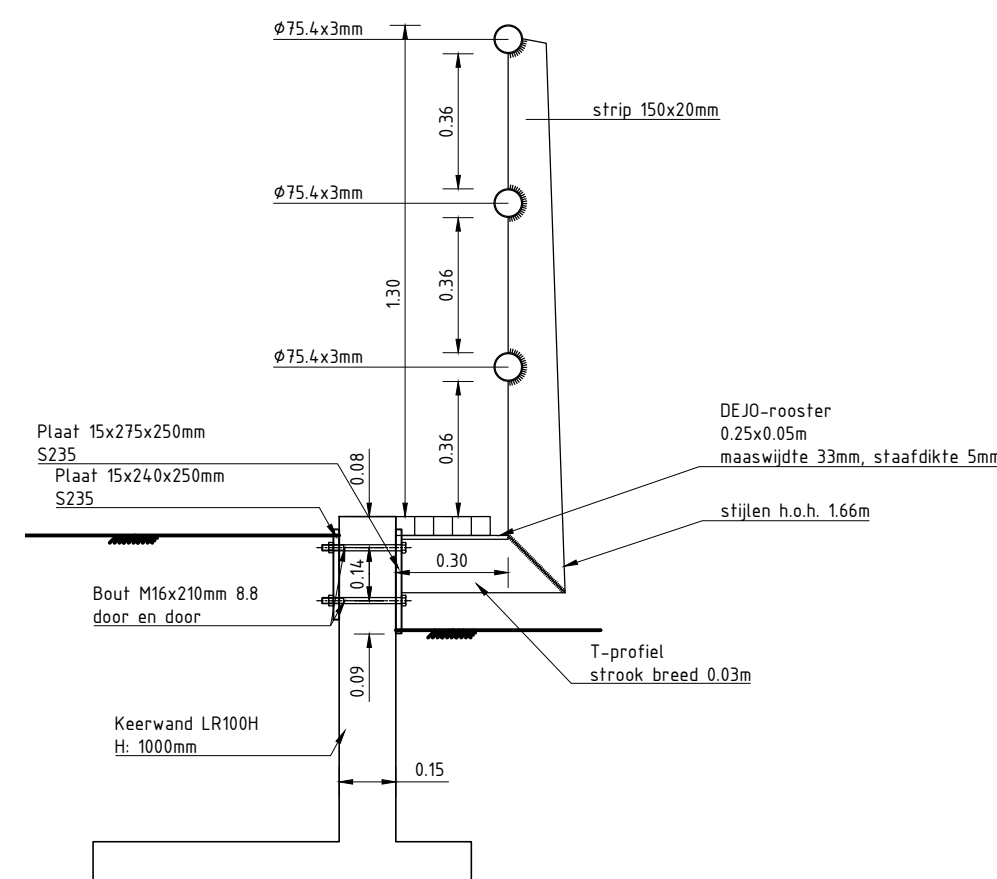

Principedetail M
Bevestiging leuning aan keerwand
Schaal 120

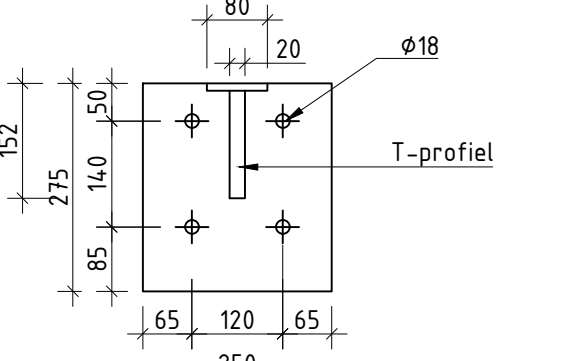

Principedetail voetplaat
Schaal 110

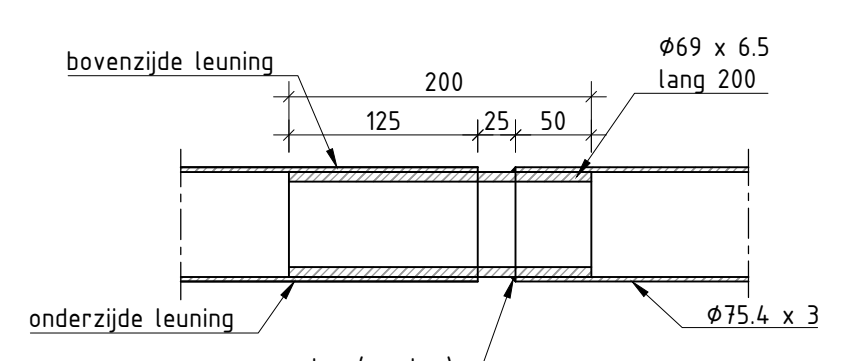

Principedetail schuiflas leuning
maten in mm
Schaal 15

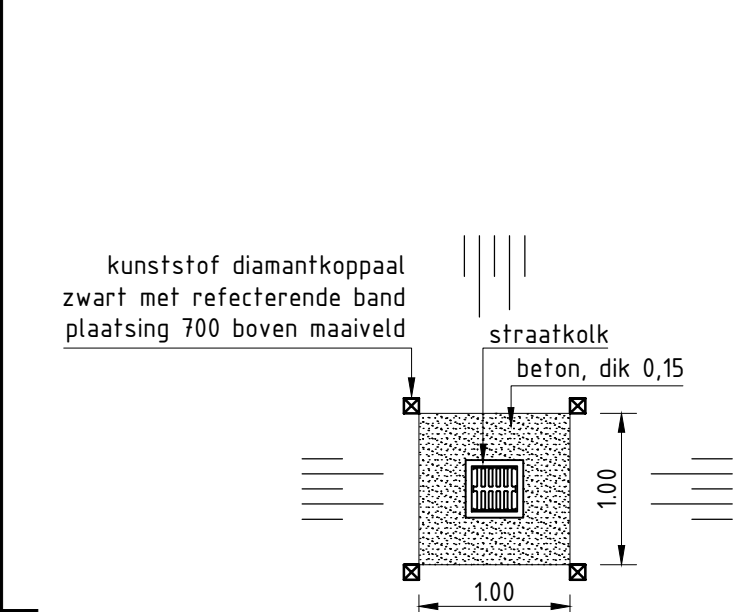

Detail opvangput
Schaal 150

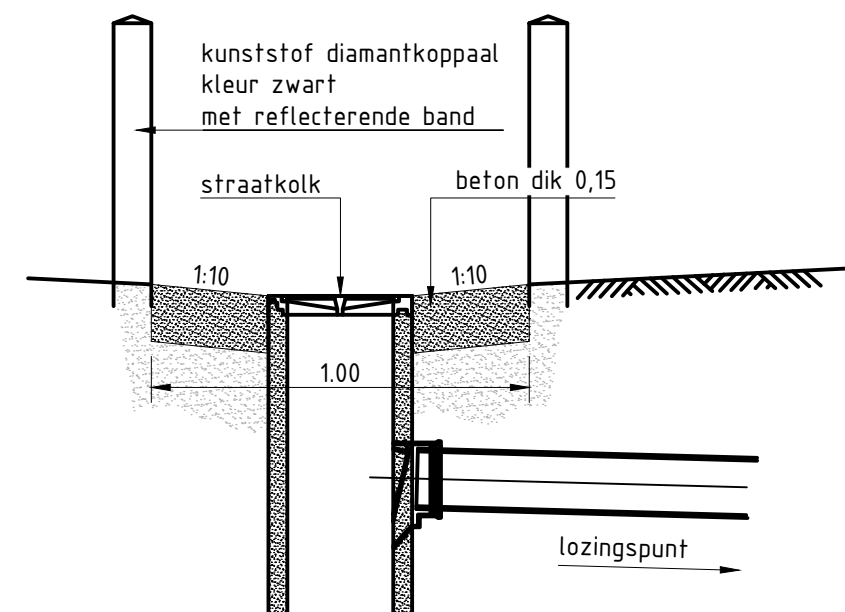

Detail opvangput
Schaal 120

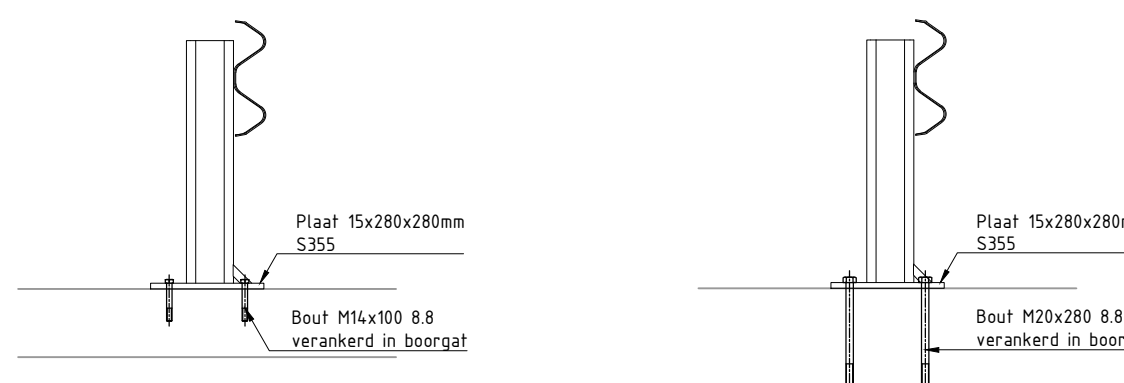

Principedetail J
Bevestiging geleiderail op brugdek
Schaal 120

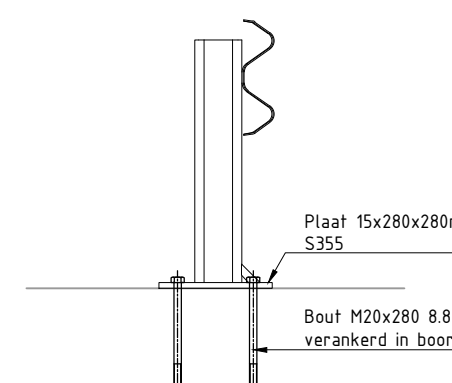

Principedetail J
Bevestiging geleiderail op dwarsbalk
Schaal 120

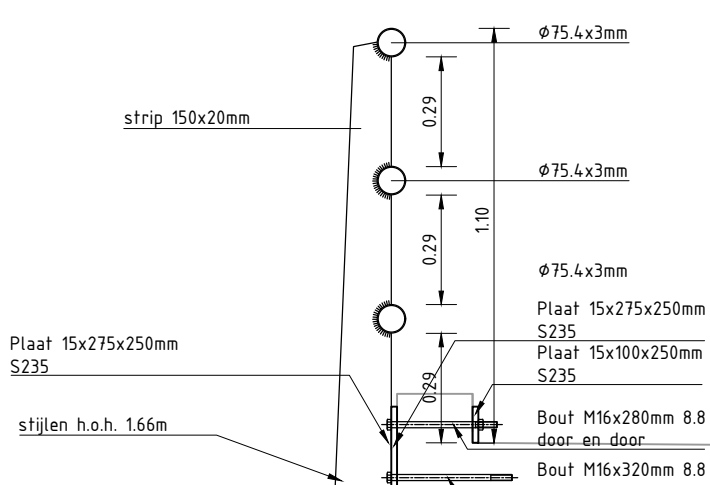

Principedetail L
Bevestiging leuning aan brug
Schaal 120

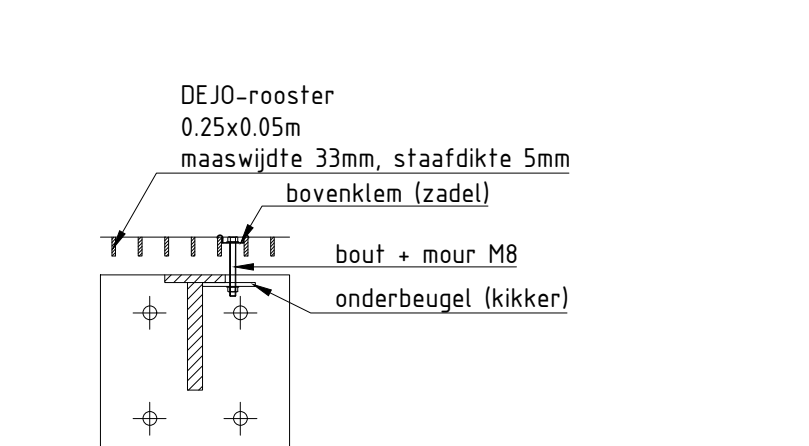

Principedetail bevestiging roosters
Schaal 110

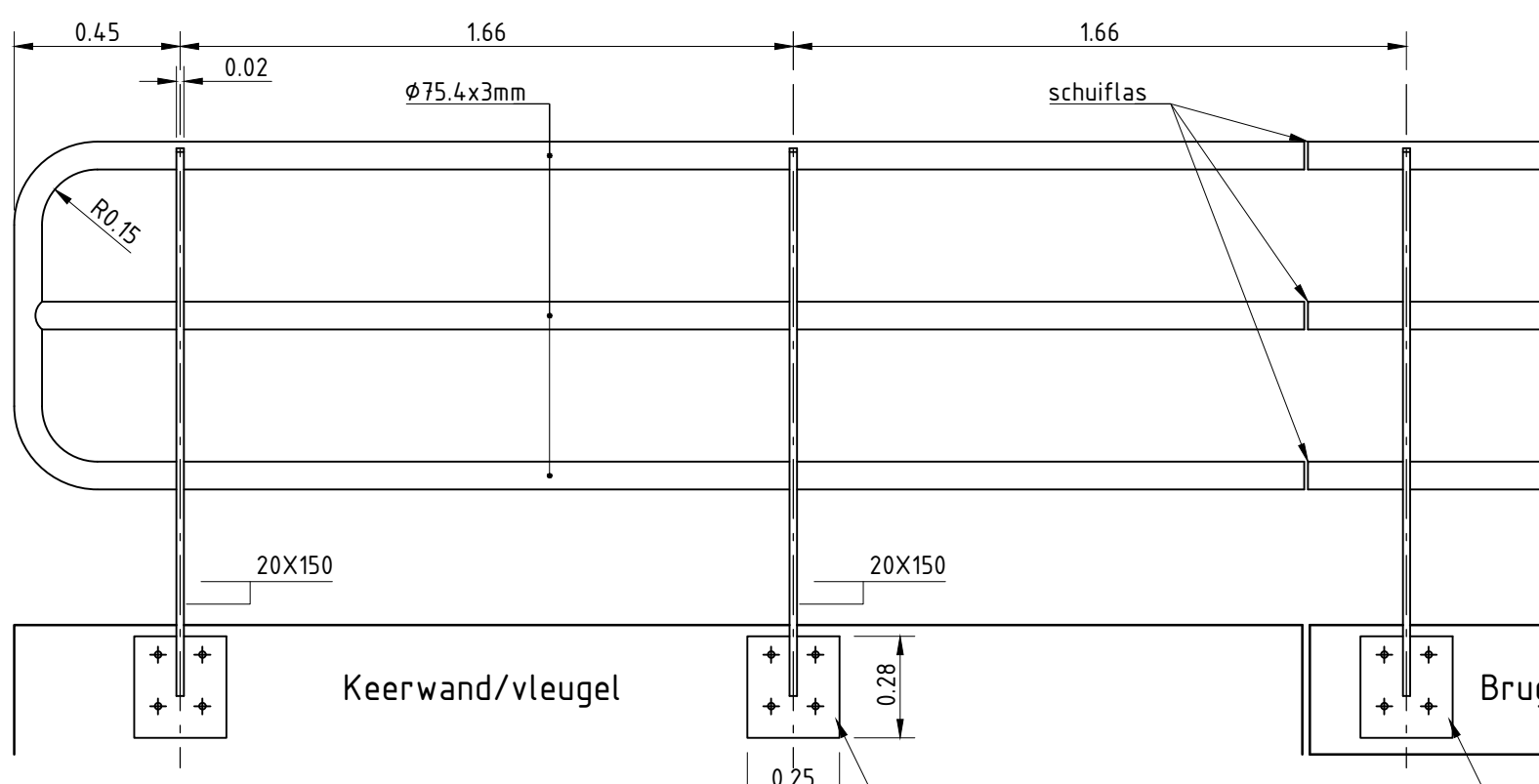

Zijaanzicht leuning
Schaal 120

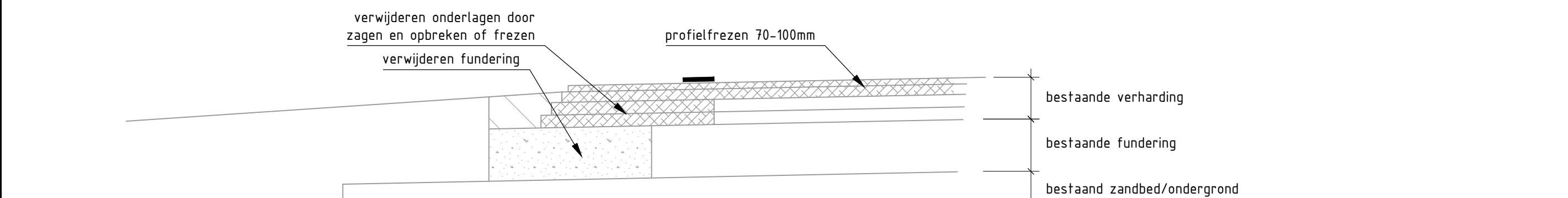

Principedetail M
Versmallen wegverharding, situatie met dek- tusselaag vervangen
bestaande situatie
Schaal 120

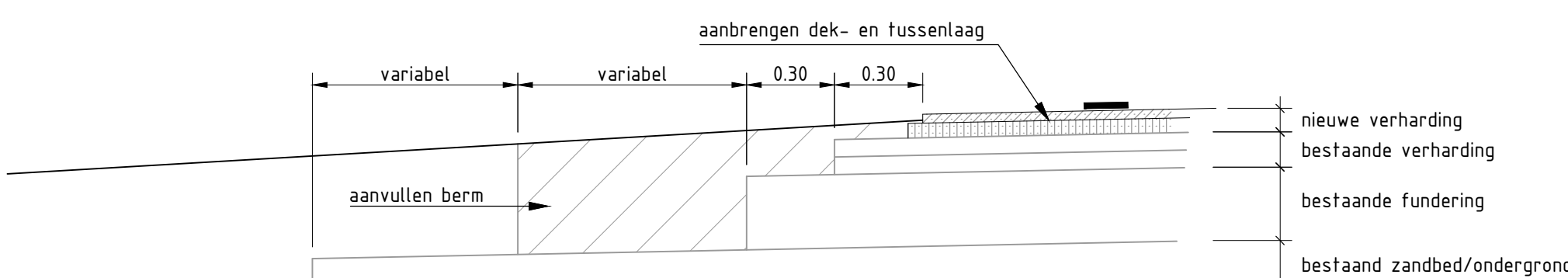

Principedetail N
Versmallen wegverharding, situatie met dek- tusselaag vervangen
nieuwe situatie
Schaal 120

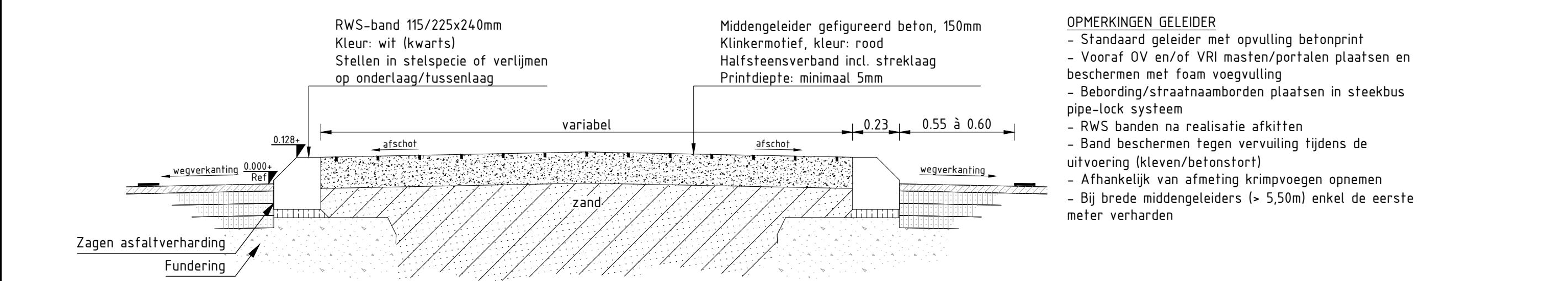

Principedoordrsnede
Middengeleider (standaard oplossing)
Schaal 120

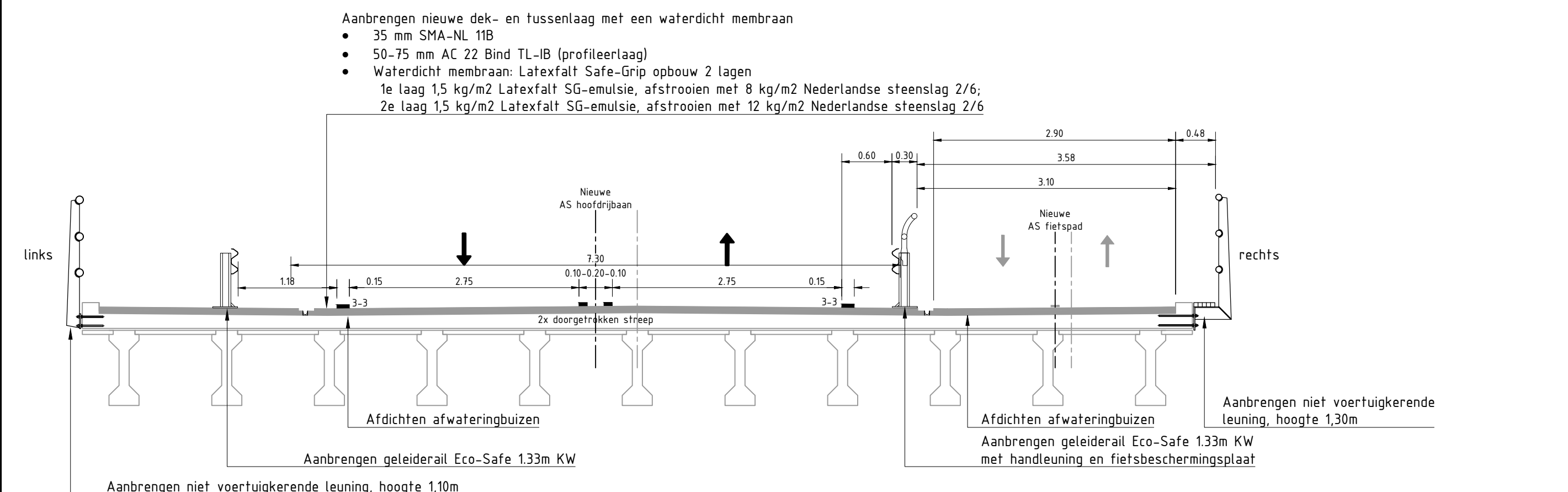

Principedoordrsnede
Kunstwerk
Schaal 150

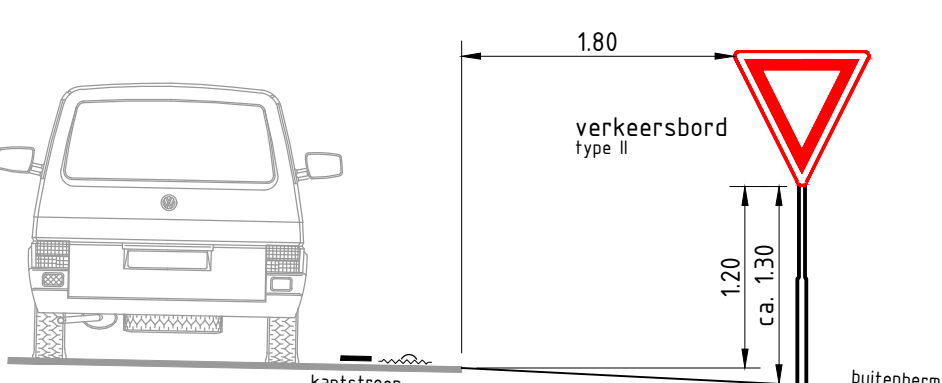

Bebording GÖW en RSW
Schaal 150

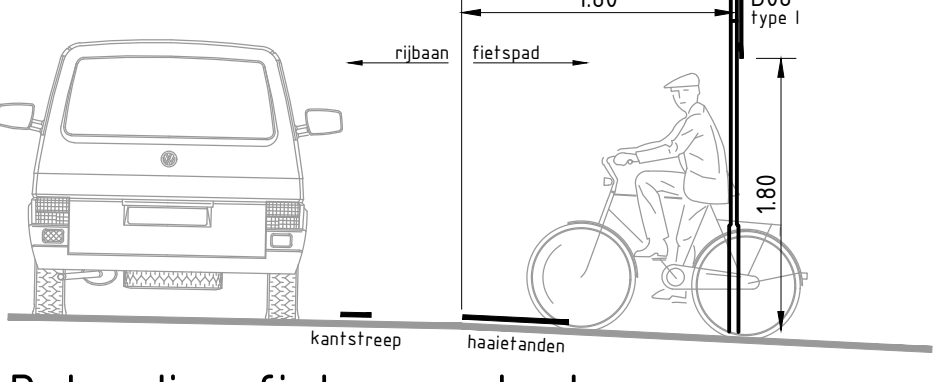

Bebording fietsoversteek
Schaal 150

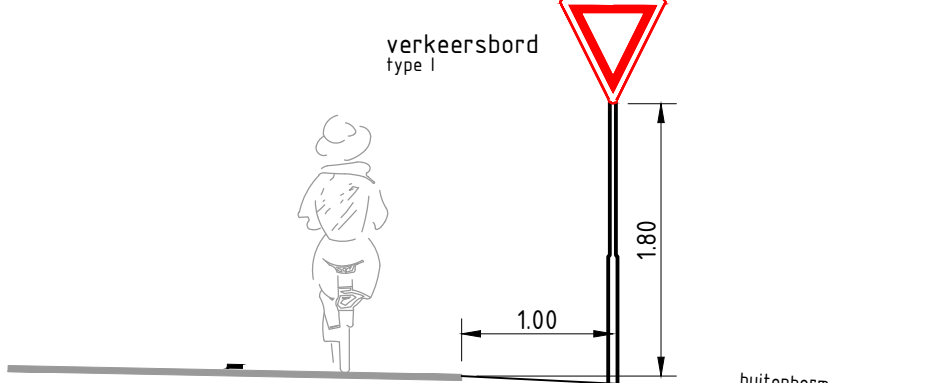

Bebording fietspaden
Schaal 150

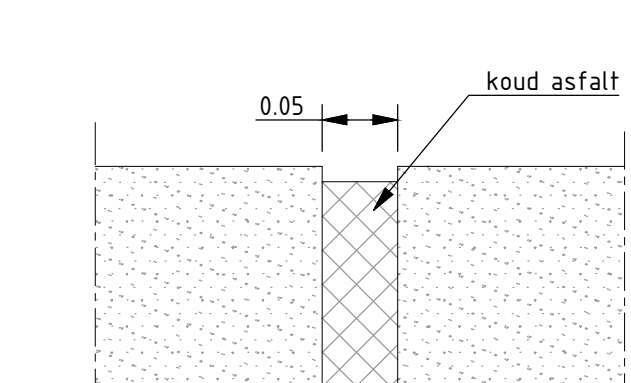

Uitzetvoeg
Schaal 15

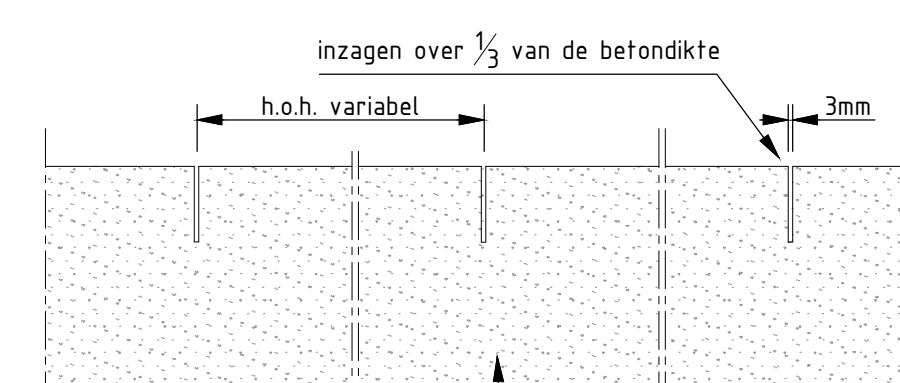

Krimpvoeg
Schaal 15

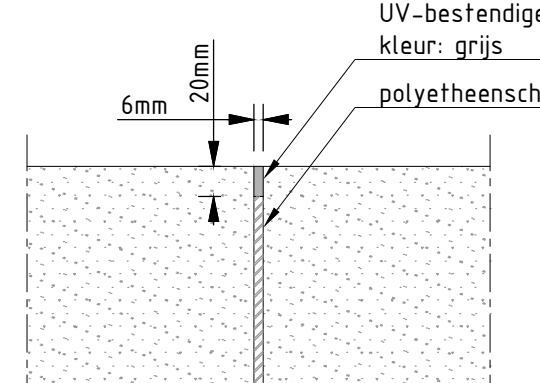

Aansluitvoeg
Schaal 15

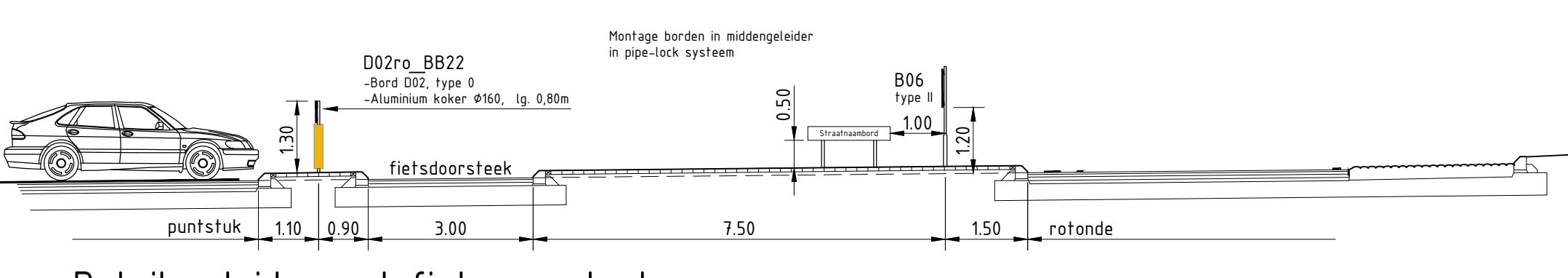

Detail geleider met fietsoversteek
Schaal 1100

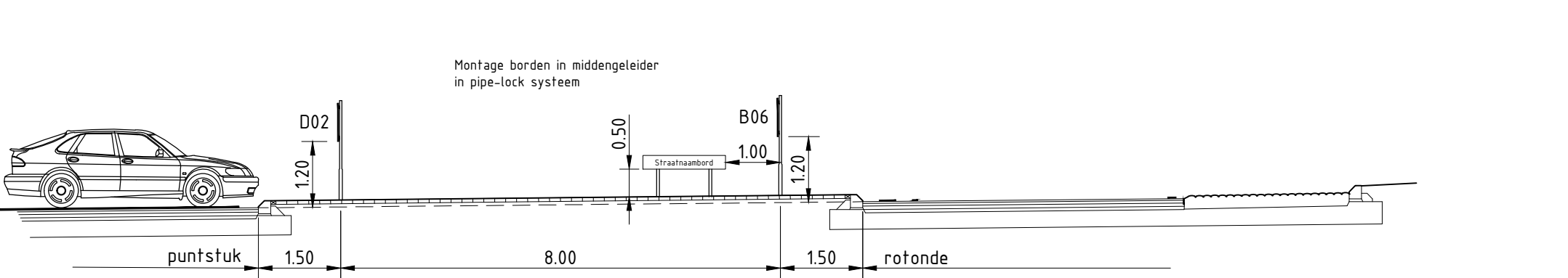

Detail geleider
Schaal 1100

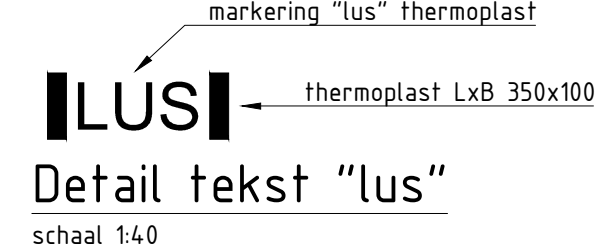

LUStekst
Schaal 140

| BESTEKSTEKING | DEFINITIEF |
|--|---|
| Niet jaarlijks onderhoud wegen en rotondes Spiekweg tussen km. 9.5 en km. 11.5 PRINCIPEDETAILS EN PRINCIPEDOORSNEDEN | Proj. no.: 25121 Bestek no.: - Dossier no.: - |
| get.: jbr 13-03-2026 gez.: kvd 13-03-2026 | gew.: revisie: A01 |
| formaat: A1+ (594x1050mm) | tek.nr.: PFL250514 |